



SPECIAL DISTRICT PUBLIC DISCLOSURE DOCUMENT

SBC METROPOLITAN DISTRICT

As required pursuant to Section 32-1-104.8 of the Colorado Revised Statutes ("C.R.S."), this Public Disclosure Document has been prepared by SBC Metropolitan District (the "District") to provide information regarding the District.

DISTRICT'S POWERS

The powers of the District as authorized by Section 32-1-1004, C.R.S. and under its Amended and Restated Service Plan, as approved by the City and County of Denver ("City") on March 27, 2007 are to provide for the design, acquisition, construction, installation, and financing of certain water, sanitation, street, safety protection and park and recreation improvements and services within and without the boundaries of the District.

DISTRICT'S SERVICE PLAN

The District's Service Plan, which can be amended from time to time, includes a description of the District's powers and authority. A copy of the District's Service Plan is available from the Division of Local Government in the State Department of Local Affairs ("Division").

The SBC Metropolitan District is authorized by Title 32 of the Colorado Revised Statutes to use a number of methods to raise revenues for capital needs and general operations costs. These methods, subject to the limitations imposed by Section 20 of Article X of the Colorado Constitution ("TABOR"), include issuing debt, levying taxes, and imposing fees and charges. Information concerning District directors, management, meetings, elections, and current taxes are provided annually in the Notice to Electors described in Section 32-1-809(1), C.R.S., which can be found at the District office, on the District's website, on file at the Division, or on file at the office of the Clerk and Recorder of City and County of Denver.

DISTRICT MAP

A map of the District's boundaries is attached hereto as Exhibit A.

Dated this 8th day of December, 2014.

EXHIBIT A

District Map



SBC Metropolitan District

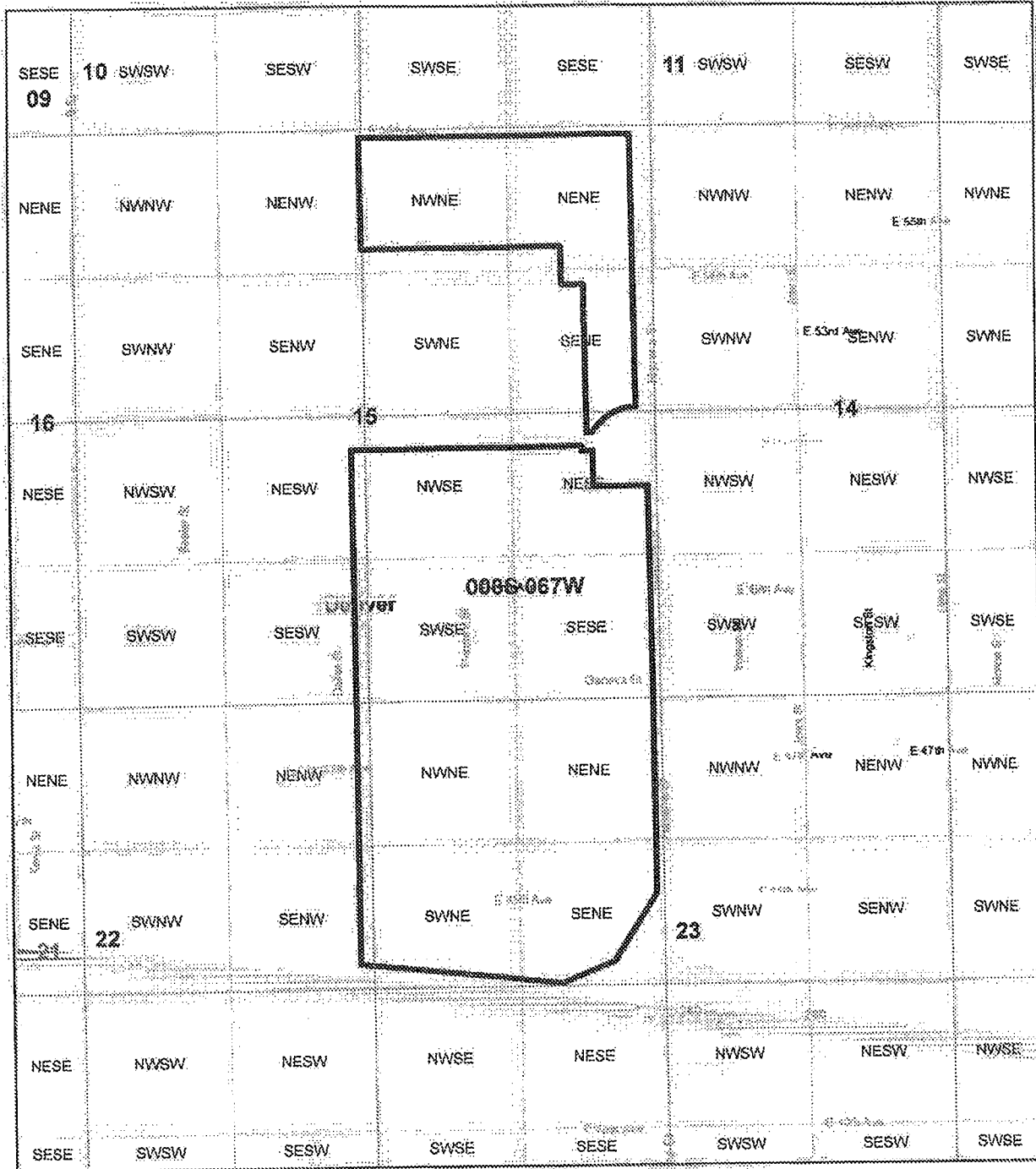

LGID 16028 / Date: Jan 30, 2011

Legal Descriptions
16028_SBCMD_O_052698
16028_SBCMD_I_101810

Legend

— District Boundary

